

SMART-CB6

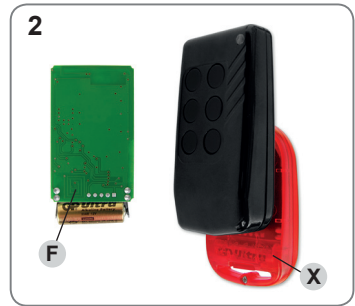
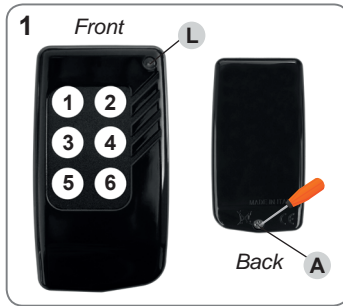

Remote Control

WARNING! At the first usage, do the self-generating code.

► BATTERY AND OPENING OF THE REMOTE CONTROL [1]

Open the case with a screwdriver removing fixing screw **A**. When the battery is replaced, check the polarity. Keep the battery away from children. Dispose of the old battery in the correct manner and according to your local regulations.

► CODE GENERATION [1]

The first button of remote control will already have a code assigned (created by NOLOGO during testing) and the second button has no code assigned. This operation creates new codes for both buttons and cancels the previous codes.

20 BITS CODE

- Press button no.1 and then button no.4 and keep them pressed.
- LED L flashes slowly.
- Wait 8 seconds until led flashes faster.
- Release button no. 1 and after a while button no. 4.

GENERATION ROLLING CODE

- Press button no.1 and button no.4 and keep them pressed.
- LED flashes slowly.
- Wait 8 seconds until the l.e.d. flashes faster.
- Release button no.1, (red l.e.d is still flashing).
- Press and release button no.1.
- LED confirm the generation of the rolling code.

Now every button has a generated code from millions of different combinations.

► 15 BUTTONS FUNCTION

SMART CB has 6 channels with the possibility to activate 15 channels To execute the procedure make as follow:

- Press button **3** and then button **2** and keep pressed both.
- Wait for a while until the LED start flashing faster.
- Release button no.3 and THEN button no. 2.

To cancel the 15 buttons function repeat the same procedure.

WARNING

Concerning the 15 buttons function, only the 5 buttons (RED LED) can memorize codes from another remote control, the rest 10 buttons work in self-learning. It is better to activate the self-learning procedure before activating the 15 channels function.

If you press the F button is possible to activate the 15 Buttons functions. From button no.1-5 flashes the red l.e.d, from button no.6-10 flashes the white led, from button 11-15 flashes the green led

Here are the flashing of the LED.

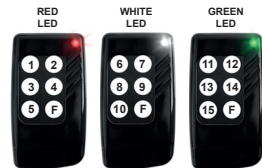

► HOW TO LEARN A CODE [1~2]

- Push the button 1 and after a while the button 4 and release them in the simultaneously.
- The led L is flashing for 5 seconds, and this is the limit time to memorize codes.
- Then press and keep pressed one of the button you need to memorize the original code 1,2,3,4,5,6.
- Press and keep pressed the button of the original remote control **X** as shown in the picture no.2, pay attention that the antenna of the original remote control **X**, usually in front of the remote control (check it by opening the remote control) should be as near as possible of the antenna **F** of the SMART-CB.

The light **L** flashes fastly for a while and then it flashes regularly to confirm that the code has been copied.



1096 Budapest, Mester utca 34. Tel.: *218-5542, 215-9771, 215-7550, Mobil: 30 940-1970, 20 949-2888
1141 Budapest, Fogarasi út 77. Tel.: *220-7940, 220-7814, 220-7959, 216-7017, 216-7018 Fax: 218-5542, 220-8881, 364-3428 Mobil: 30 531-5454, 30 959-0930

E-mail: delton@delton.hu Web: www.delton.hu

www.delton.hu